

Wall&Pole Mount

SBP-400WMW

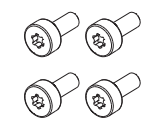

Package

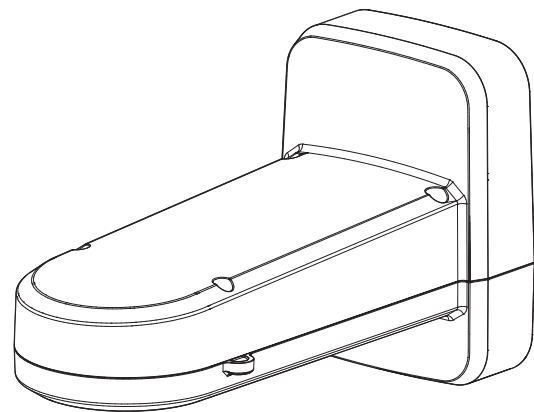

Screws (4EA)

Optional Accessory

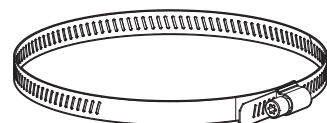

Steel Strap:
SBP-060S (600mm)
SBP-150S (1500mm)

PT01-006118A

Installation Precautions

- Make sure that the installation place can endure at least 4 times of the total weight of the Wall&Pole Mount and Camera.
- Each anchor screw must be capable of withstanding an extraction force of 700 kg.
- When using PoE injector at internal space, we do not recommend to use booted mold type RJ45 connector for cabling.
- During installation procedure, safety wire can be used between the site and side hook on the mount to sustain.

Mounting Hole Guide

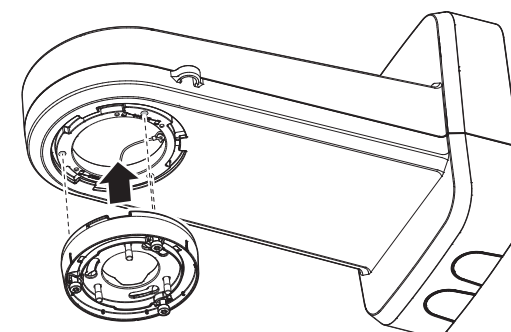
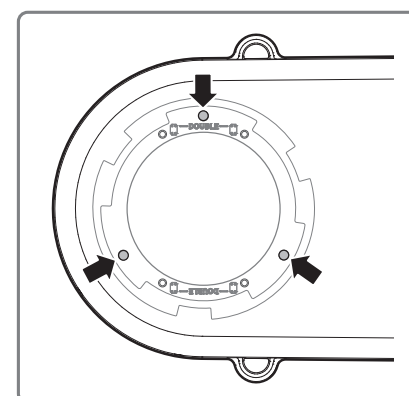
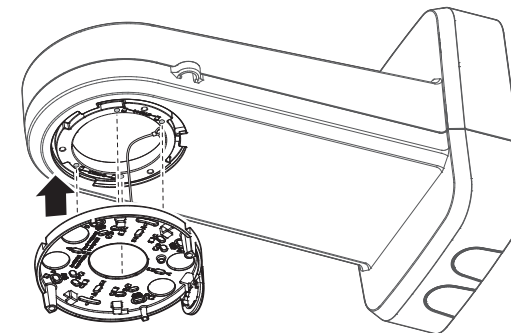
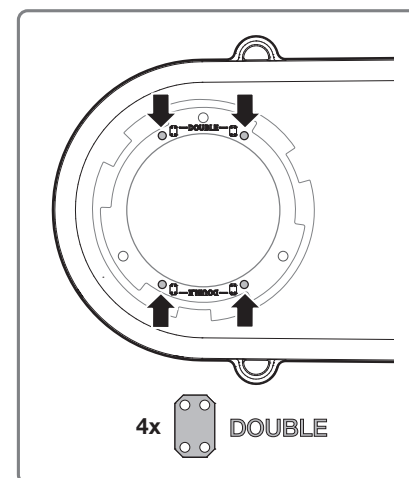

Installation

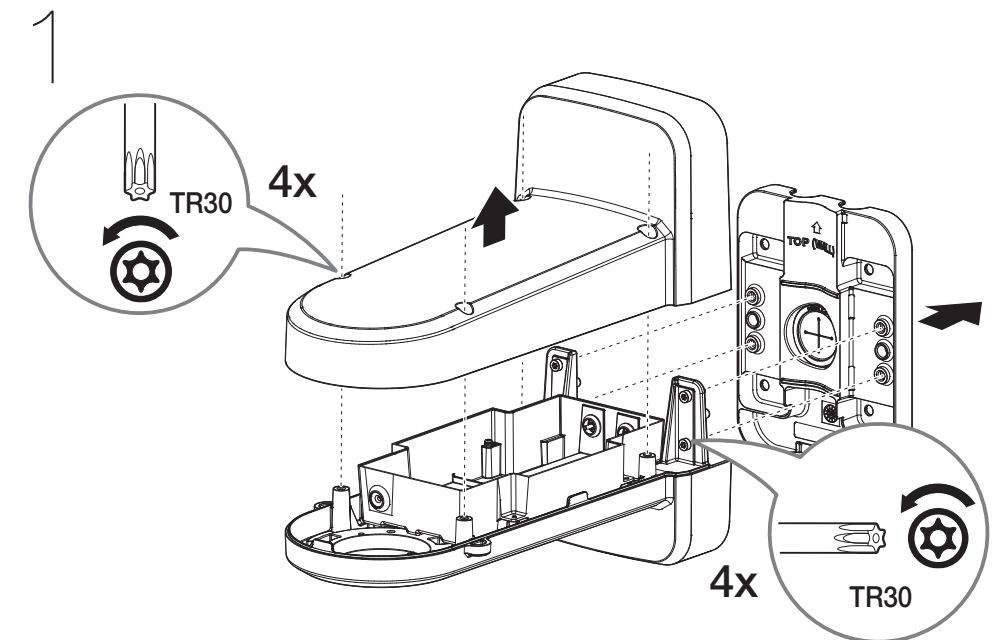

2 (Wall)

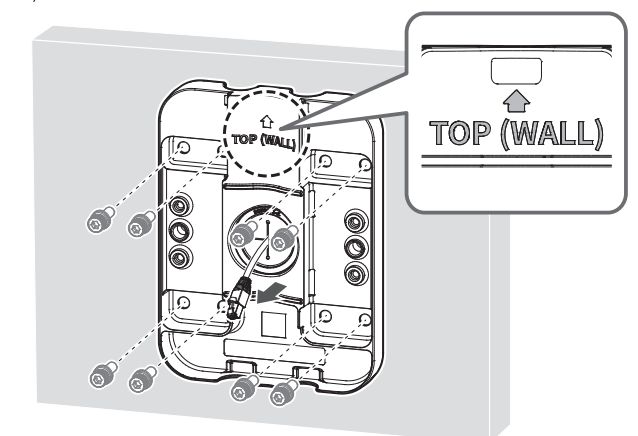

(Pole)

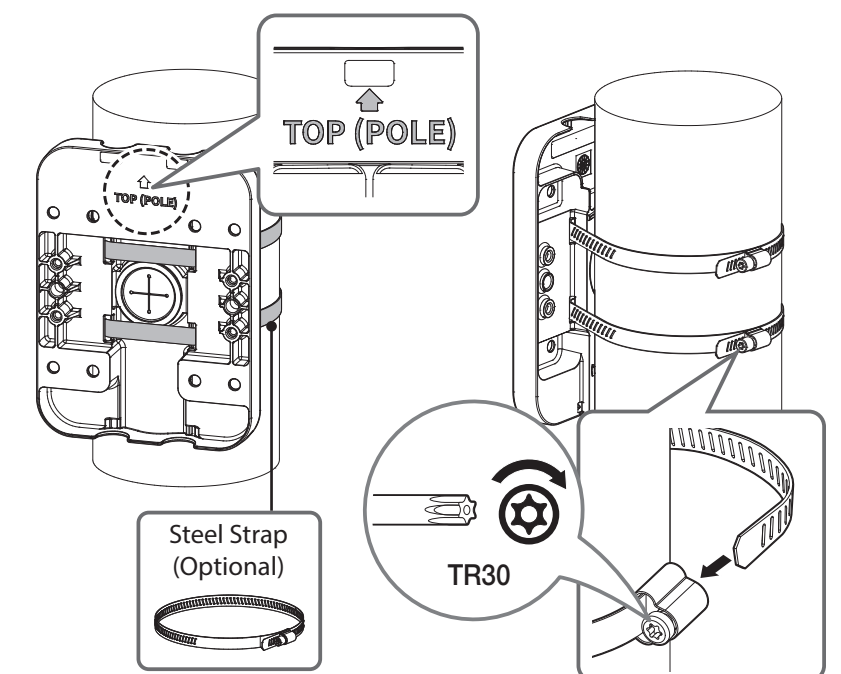

When using conduit (3/4")

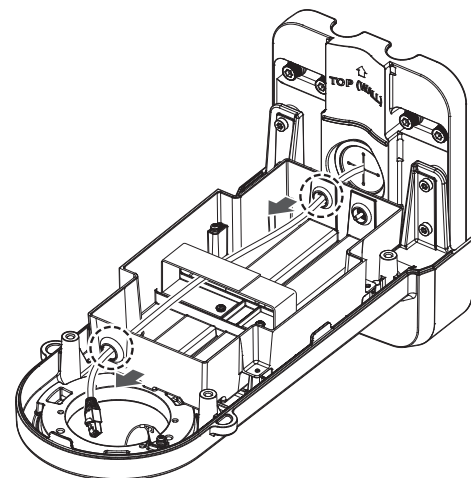
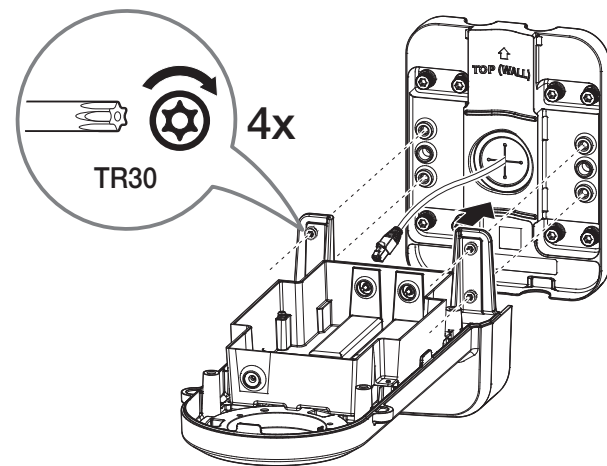
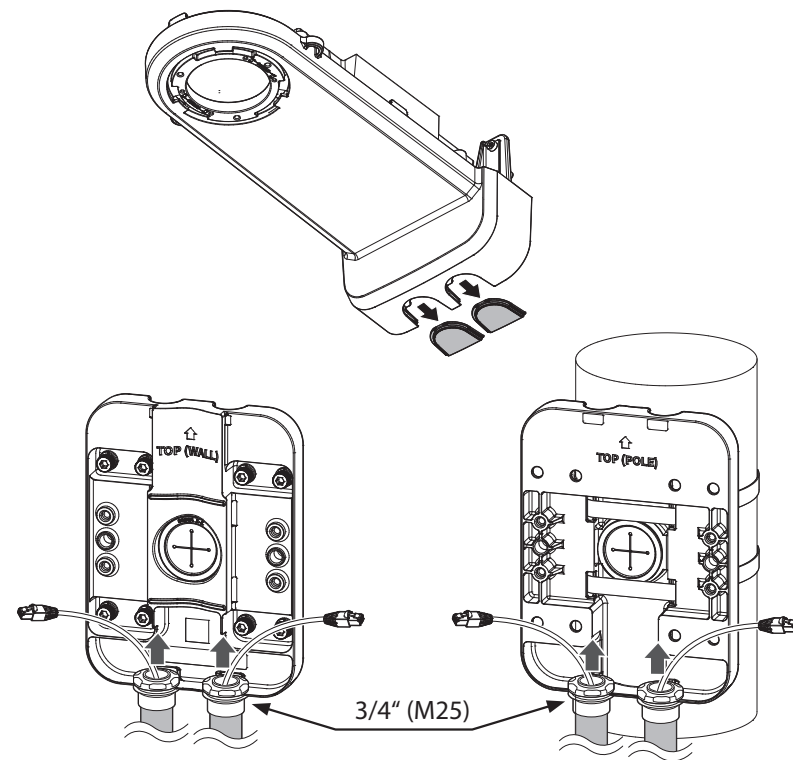

When using PoE Injector

* The SPO-6011 injector installation is the same as in SPO-8315 except for the ground connection.

* We do not recommend to connect SFP cabling when using SPO-8315 and SPO-6011.

