

Unpacking

Before using the device, check the device model and ensure that the shipped box includes the following items:

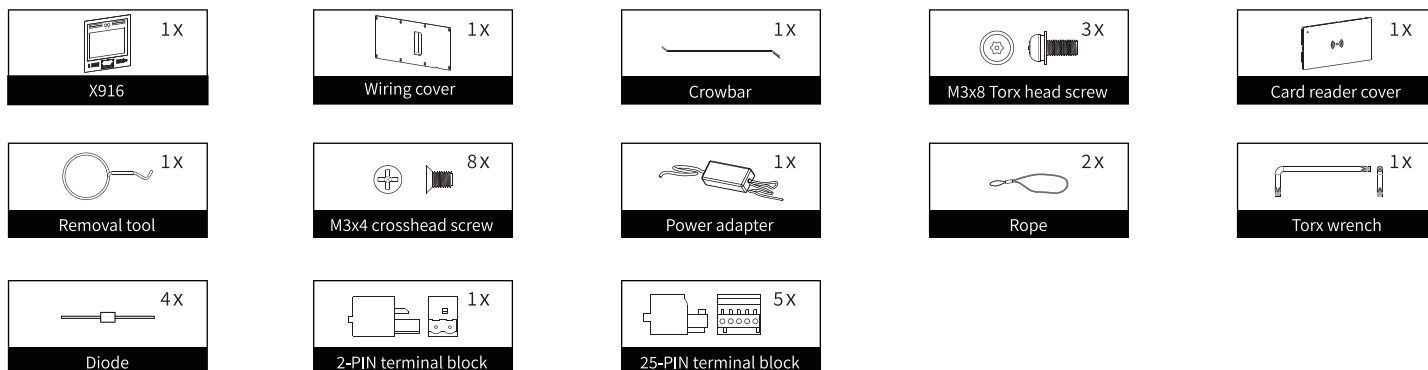

Optional Accessories:

Wall-mounting Accessories (Please find in On-Wall Installation Kit box)

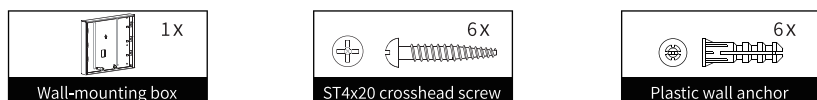

Flush-mounting Accessories (Please find in In-Wall Installation Kit box)

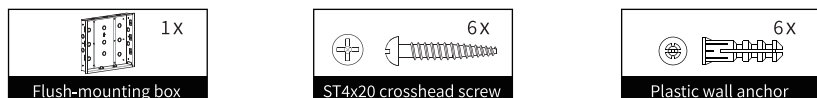

Product Overview



Before You Start

Tools needed

(not included in shipped box)

- Cat Ethernet Cable
- Crosshead Screwdriver
- Electric Drill

Voltage and Current Specifications

- It is suggested that use PoE+, 12VDC 4A or 24VDC 2A power adapter to power on device.

AWG Sizes and Properties Table

Power Supply		12VDC 4A or 24VDC 2A				
AWG		12	14	16	18	20
Resistance (ohm/km)		5.31	8.45	13.5	21.4	33.9
Cross-sectional Area (mm ²)		3.332	2.075	1.318	0.8107	0.5189
Wire Length (m)	12V 4A	≤30	≤20	≤10	≤5	\
	24V 2A	≤40	≤30	≤20	≤10	≤5

Requirements

1. Place the device away from sunlight and light sources to prevent potential damage.
2. Do not place the device in the high-temperature, and humid environments or in surroundings impacted by magnetic field.
3. Install the device on the flat surface securely to avoid personal injuries and property loss caused by device's falling.
4. Do not use or place the device near heating objects.
5. If installing the device indoors, please keep device at least 2 meters away from light, and at least 3 meters away from window and door.

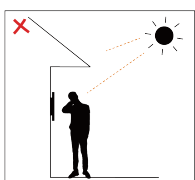

Backlight

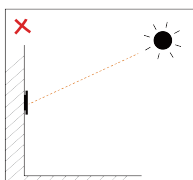

Direct sunlight

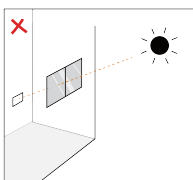

Direct sun
through window

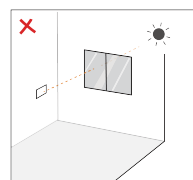

Indirect sunlight
through window

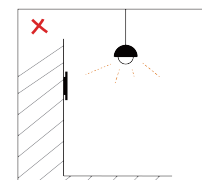

Close to light

Warning!

1. To ensure safety, avoid touching power cord, power adapter, and device with wet hands, bending or pulling the power cord, damaging any components, and use only qualified power adapter and power cord.
2. Be careful that standing up on the area under the device in case of personal injuries cause by hitting the device.

Caution

1. Do not knock device with hard objects.
2. Do not press down hard on the device screen.
3. Do not expose device to chemical products, such as alcohol, acid liquid, disinfectants, and so on.
4. To prevent the device installation from becoming loose, ensure accurate diameters and depths of screw holes. If the screw holes are too large, use glue to secure the screws.
5. Use wet cloth clean device surface softly, and then wipe the surface with dry cloth for cleaning the device.
6. If there is abnormal situation of the device, including uncommon sound and smell, please power off the device and contact Akuvox Technical Team immediately.

Wiring Interface

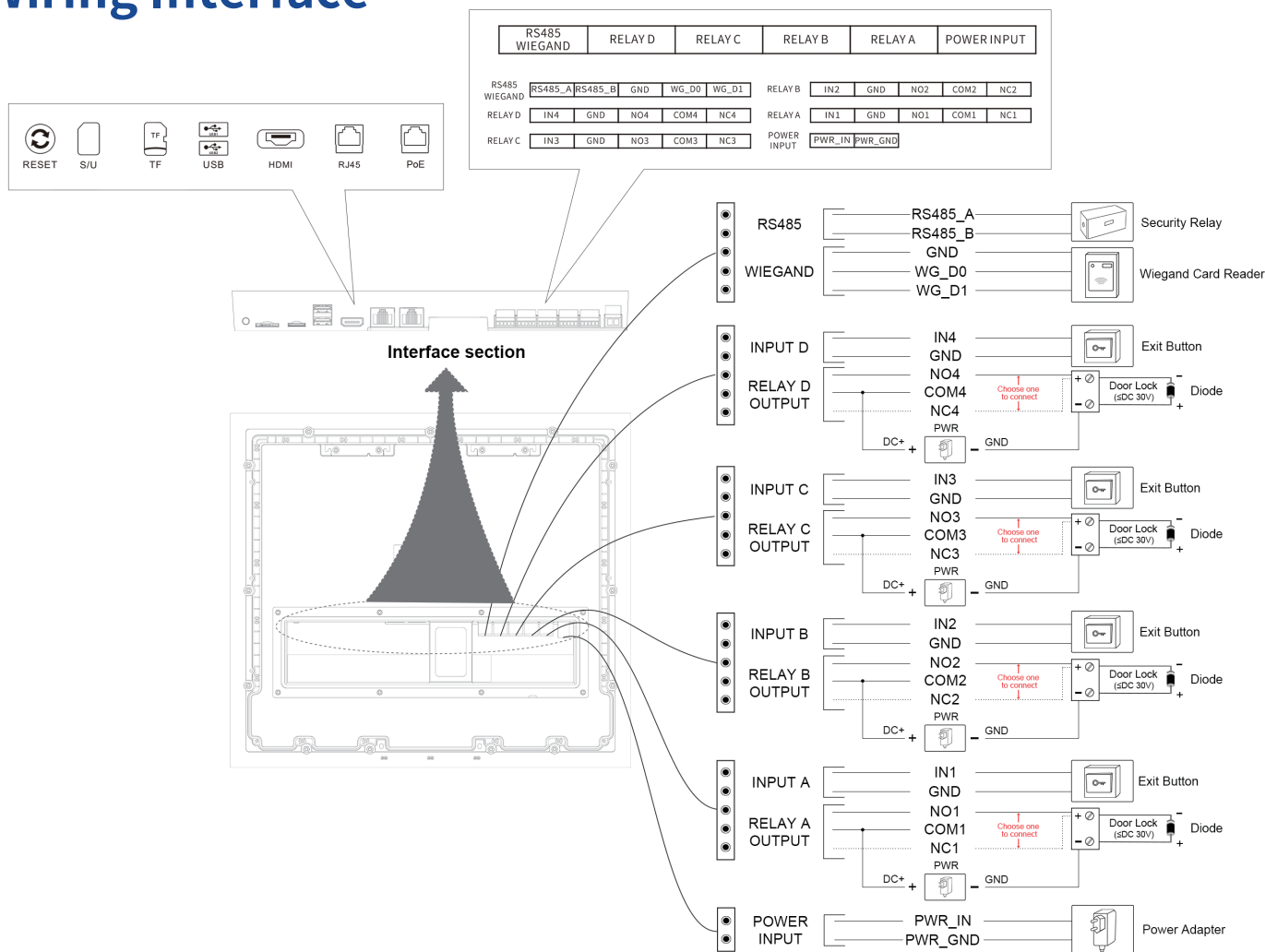

To protect the device from potential damage caused by over-voltage, it is recommended to wire a diode into the circuit. Connect the anode of the diode to the negative cable of the lock, and connect the cathode of the diode to the positive cable of the lock.

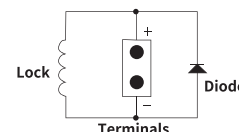

Installation

Step 1: Box Installation

1. Wall-mounting

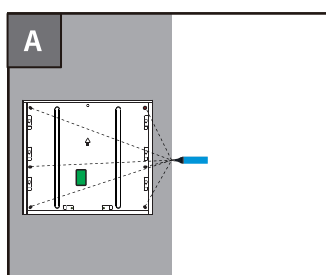

- Hold the back of the **wall-mounting box** close to the wall, and ensure that wiring hole on box should align to cable position on the wall.
- Mark the six holes of the **wall-mounting box** on the wall.

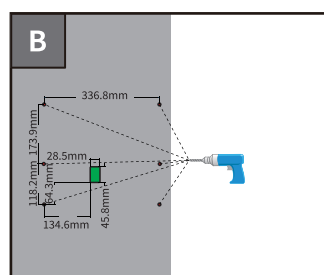

Take off the **wall-mounting box** and use a drill with 6mm diameter bit to make holes in the marked positions.

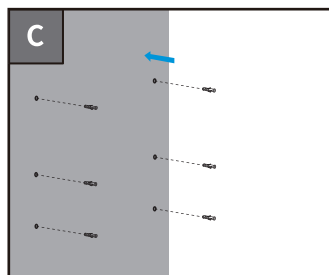

Insert the **plastic wall anchors** into the holes.

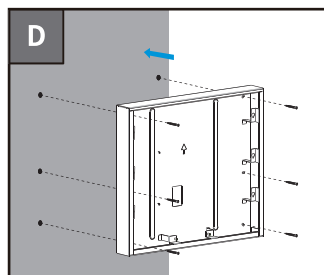

Fix the **wall-mounting box** with six **STx20 crosshead screws**.

2. Flush-mounting

2.1 Normal Installation

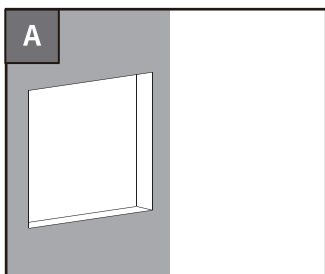

Cut a rectangular hole on the wall of the diameter of 358x319mm and depth of 58mm that can accommodate and through out all necessary cables.

Note: The size of the hole should be a little larger than recommendation.

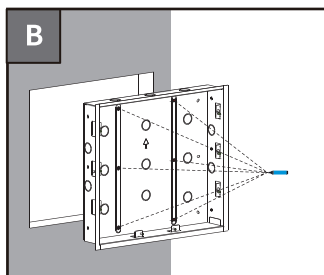

- Insert the **flush-mounting box** into the hole and make sure the cables of the device can route through the suitable cable holes.
- Mark the six holes of the flush-mounting box on the wall.

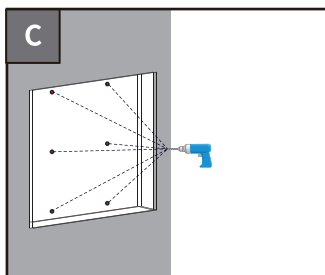

Take off the **flush-mounting box** and use a drill with 6mm diameter bit to make holes in the marked positions.

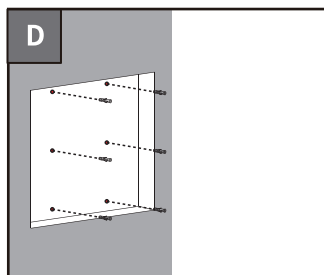

Insert the **plastic wall anchors** into the holes drilled before.

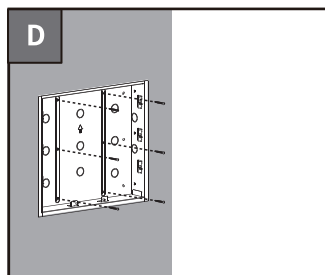

- Place the **flush-mounting box** into the rectangular hole and route all cables through the cable holes.
- Fix the **flush-mounting box** with six **ST4x20 crosshead screws**.

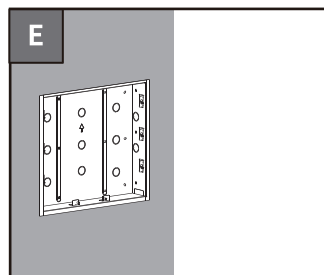

Flush-mounting box is installed.

2.2 Simple Installation (with lower resistance of vandalism)

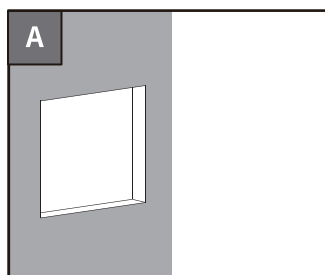

Cut a rectangular hole on the wall of the diameter of 358x319mm and depth of 58mm that can accommodate and through out all necessary cables.

Note: The size of the hole should be a little larger than recommended value.

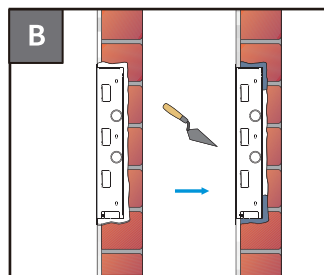

- Use cement or non-corrosive structural adhesives to fill the gap between the wall and **flush-mounting box**.
- Wait the adhesive material desiccation, go to the next step.

Note: To prevent water from entering the back cover of the door phone, it is recommended to fill the gaps around with waterproof material.

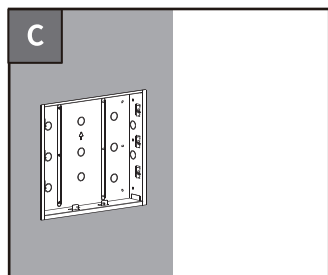

Flush-mounting box is installed.

Step 2: Main Unit Installation

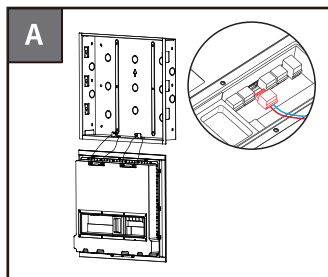

- For convenient wiring, hang X916 on the **flush-mounting box** with **rope**.
- Connect the **terminal blocks** to the cables as needed. **2-PIN terminal block** can only be used for power Input port. For details, refer to **Wiring Interface**.

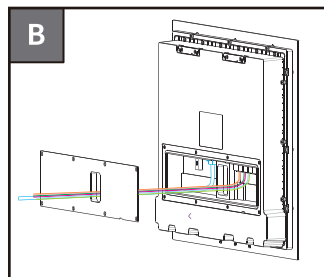

- Make cables of the installed **terminal blocks** go through the hole of the **wiring cover**.
- Connect to the corresponding interfaces of the main board.

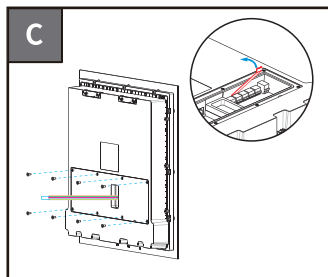

- Fasten the **wiring cover** with eight **M3x4 crosshead screws**.
- If you need remove **terminal blocks**: Insert the end of the crowbar without the thin steel sheet between the device and the **terminal blocks**.
- Pry up the **terminal blocks** in the direction of the arrow in the figure.

Step 3: Device Mounting

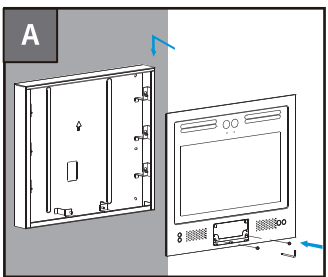

- Insert the device into the **wall-mounting box/flush-mounting box**.
- Pull the device downward to ensure the six hangers on the back of which hooked to the hanging holes of the box.
- Use the **Torx wrench** to tighten the device with two **M3x8 Torx head screws**.

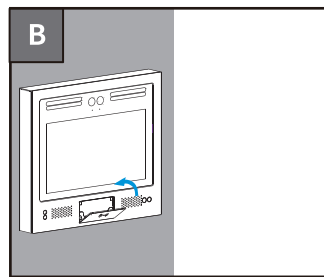

- Place the **card reader cover** into the groove of card reader area (please note that the small round hole on which must be in the upper left corner).
- Press cover around to fix it.

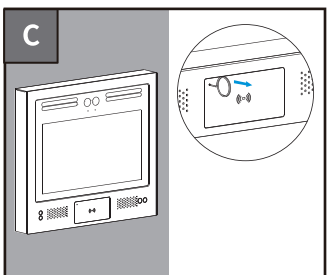

- Installation finished, please remove the protective film.
- If you need remove **card reader cover**, please use the removal tool, insert into the small round hole in the upper left corner of the card reader cover and pull it out.

Application Network Topology

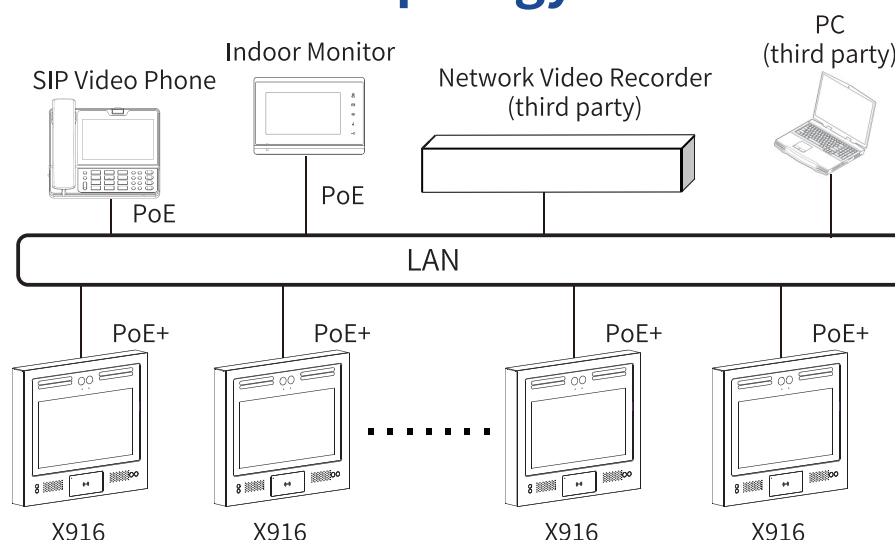

Device Test

Please verify the device status after installation:

1. **Network:** Press **Call** key, enter 9999, and tap **Call**. Then, type 3888 and tap **Confirm** to access settings page. Go to **Network settings** to check the device's IP address and network status. Network is working properly if the IP address is obtained.
2. **Intercom:** Tap **Call** key, enter the IP or SIP number and press **Dial** key to make a call. Or, tap APT number to call. The call configuration is correct if the call is successful.
3. **Access Control:** Use pre-configured PIN code, RF card, and face to unlock door.

Warranty

1. Akuvox warranty does not cover intentional mechanical damage or destruction caused by improper installation.
2. Do not attempt to modify, alternate, maintain, or repair device by yourself. Akuvox warranty does not apply to damages caused by anyone who is not representative of Akuvox or an Akuvox authorized service provider. Please contact Akuvox Technical Team if the device need to be repaired.

Get Help

For help or more assistance, contact us at:

 <https://ticket.akuvox.com/>

 support@akuvox.com

Scan the QR code to get more videos, guides, and additional product information.



Notice Information

Information contained in this document is believed to be accurate and reliable at the time of printing. This document is subject to change without notice, any update to this document can be viewed on Akuvox' s website: <http://www.akuvox.com> © Copyright 2024 Akuvox Ltd. All rights reserved.

